

Procedure to determine if the pressure sensor is faulty on Panasonic EP3000N

The following procedure should be performed if the chair is shutting down prior to any massage functions beginning.

1. Insert the Power plug into the power source and turn on the switch of the Power source switch block
2. While pushing the buttons of II and IV, continue to push the On/Off button for more than approximately three seconds. Then, the buttons of II, IV, and the USER B light up.
3. Within 10 seconds after the buttons of II, IV, and USER B light, push the buttons as follows: (1) SELF PROGRAM (2) REGIONAL ROLL (3) START
4. Move the Message mechanism block pushing the buttons of POSITION and BACK INTENSITY
5. Push the button of Stop after checking.

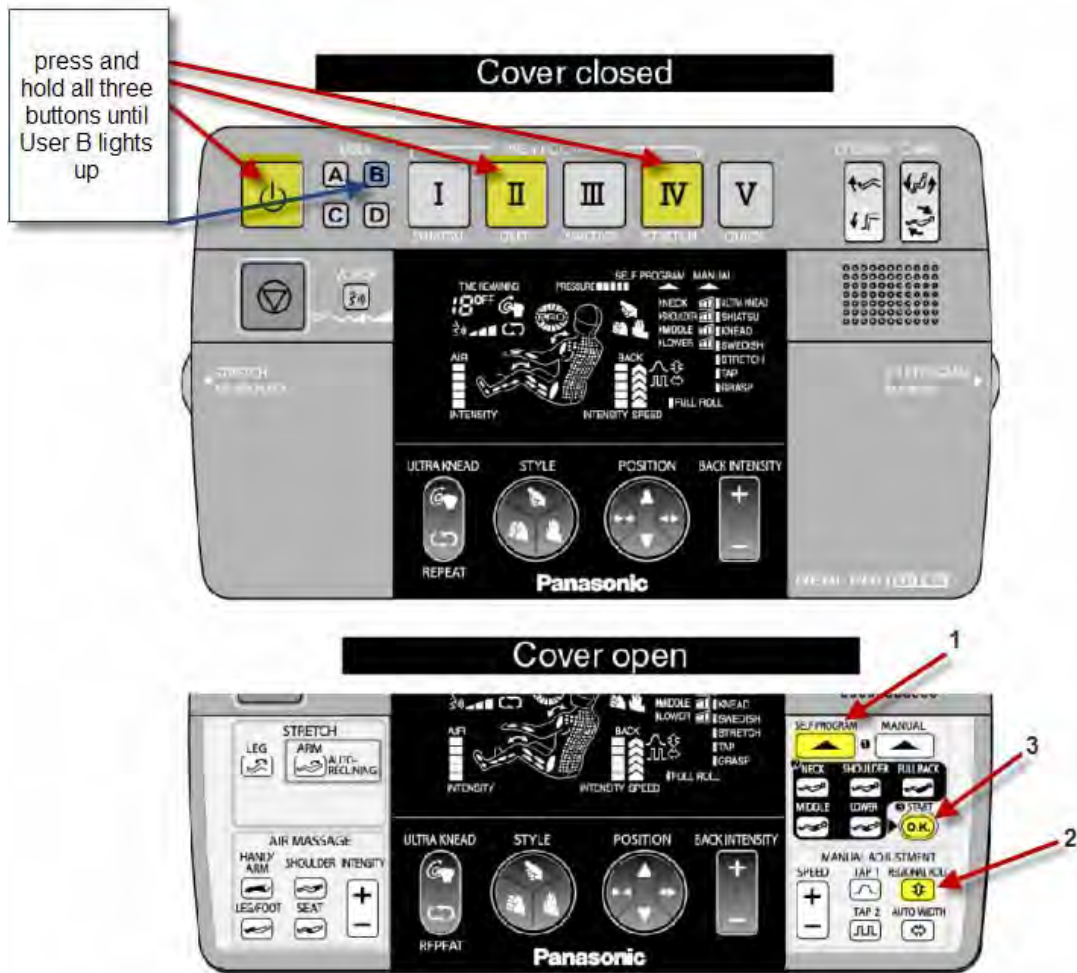

If after disabling the pressure sensor the chair functions as normal, the pressure sensor is faulty and will need replaced. If the chair continues to perform as it did prior to performing this procedure, further troubleshooting is required.